

Uno Filter Select Tap

Filter Installation Instructions

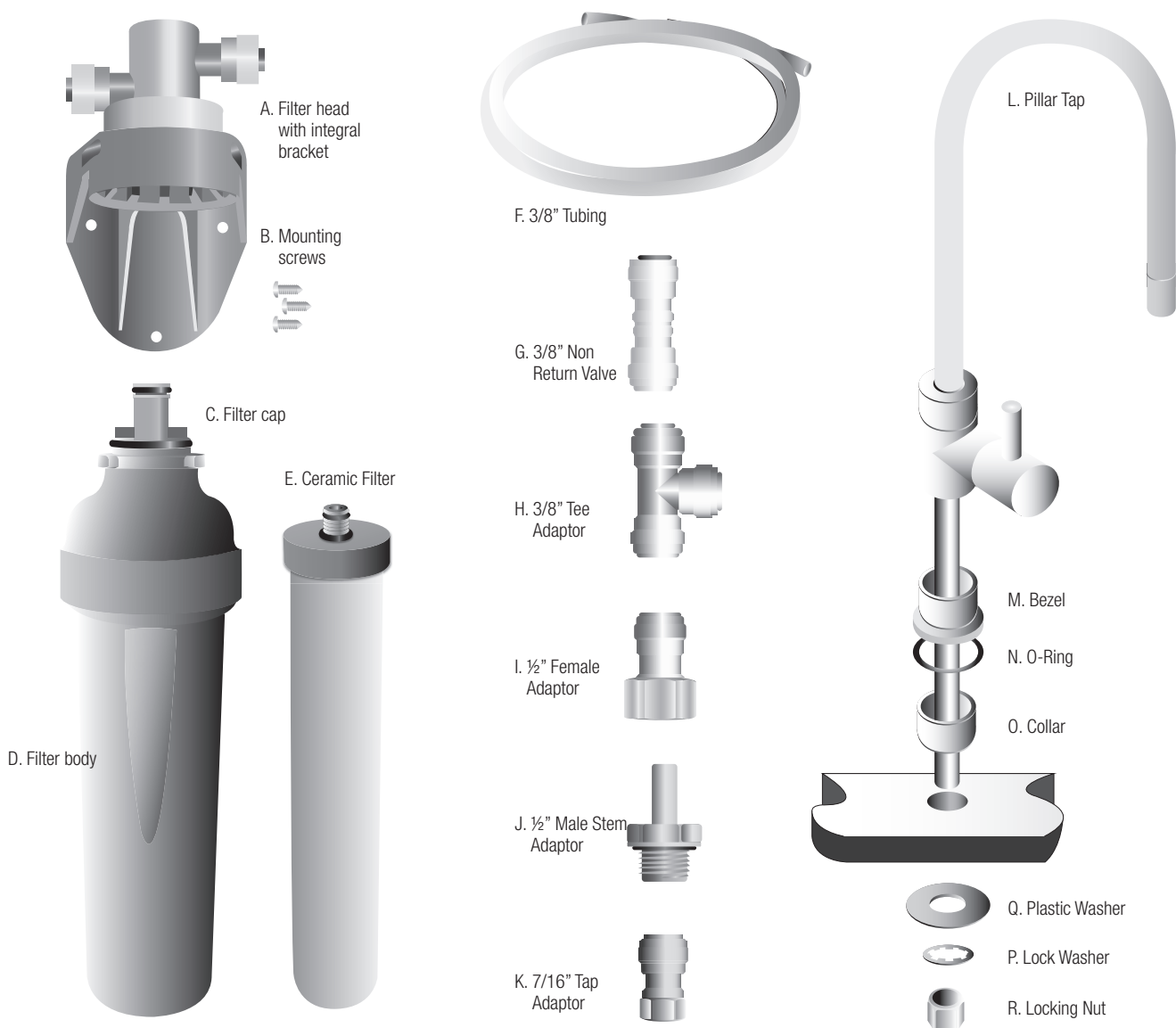

Parts included in your Uno Filter Select Tap filtration system

Filter Housing Comprising:

- A. Filter Head
- B. Mounting Screws x3
- C. Filter Cap
- D. Filter Body
- E. Ceramic Filter

Fitting Kit:

- F. 3/8" Tubing
- G. 3/8" Non Return Valve
- H. 3/8" Tee Adaptor
- I. 1/2" Female Adaptor
- J. 1/2" Male Stem Adaptor
- K. 7/16" Tap Adaptor

Pillar Tap Comprising:

- L. Pillar Tap
- M. Bezel
- N. O-Ring
- O. Collar
- P. Lock Washer
- Q. Plastic Washer
- R. Locking Nut

1. Operating Conditions

- 1.1 Maximum Working Pressure: 6bar (90psi) - This filter has satisfied the NSF/ANSI Stds 42 and 53 structural test criteria. However, due to the potential wide variations of pressures from one installation to another, the manufacturer advises that if there is any concern that the system would see pressures above 6 bar then an approved pressure reducing valve set at 6 bar should be installed upstream of the filter to eliminate any extreme variations of pressure.
- 1.2 Maximum Working Temperature: 38°C (100°F)
- 1.3 Minimum Operating Pressure: 2bar (30psi)*
- 1.4 Minimum Operating Temperature: 5°C (41°F)
*This will result in a 1L/min flow of filtered water. At 45psi or greater, a flow rate of 1.5L/min or more will be seen

2. Important

- 2.1 This filter is intended for installation under the sink away from direct sunlight
- 2.2 This filter is not designed for the treatment of hot water and should only be connected to the cold water supply
- 2.3 Maximum plastic housing life: 10 years
- 2.4 Water fittings for use in permanently pressurised systems have a finite life. It is important that the plastic components in the system are replaced after 10 years usage
- 2.5 **PLEASE NOTE: Allowing the unit to freeze will invalidate the product warranty**

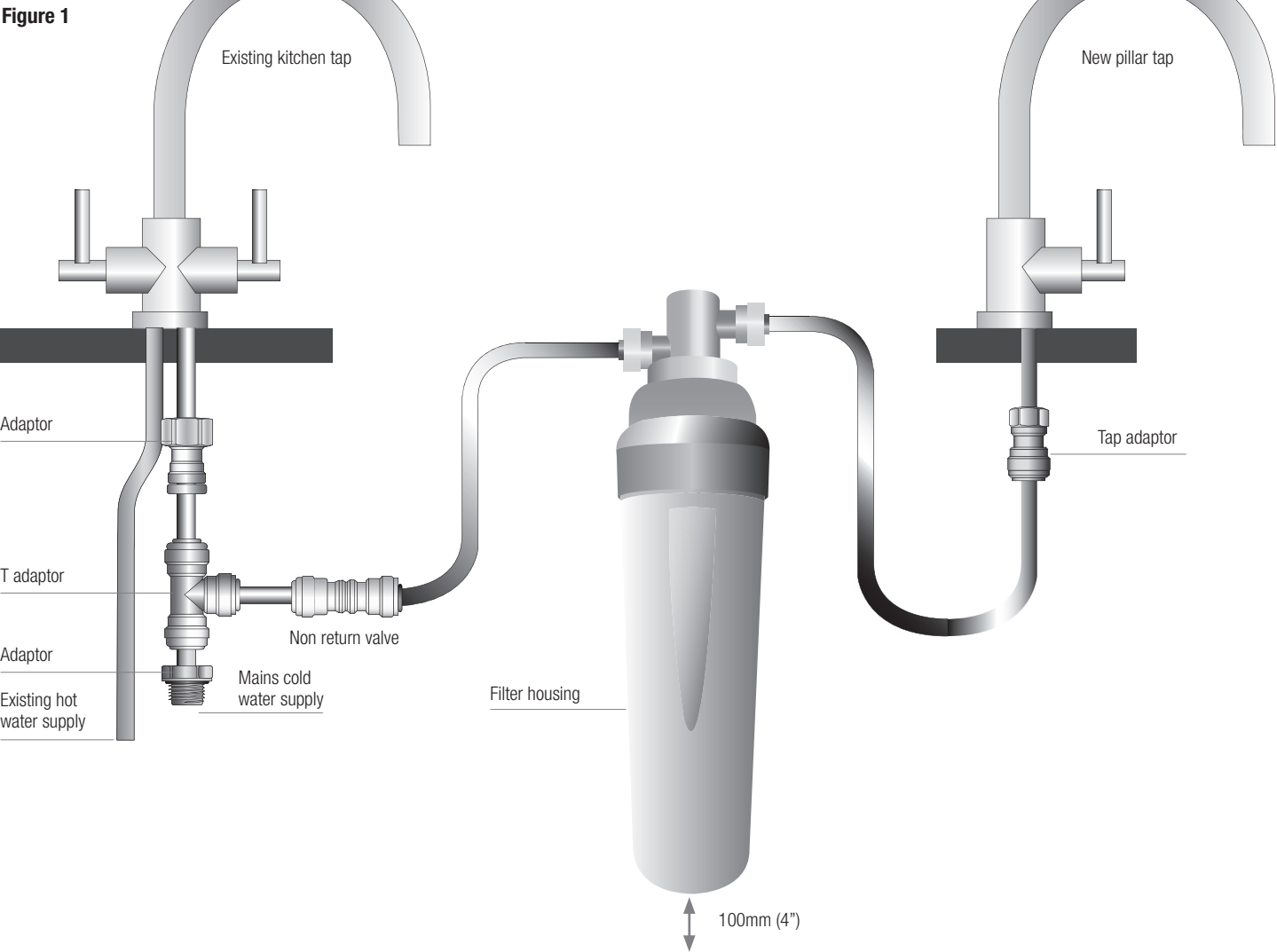

Figure 1

3. Location of the system and Preparation for Connecting Pipe work and Fittings

- 3.1 The filter is supplied with a Pillar Tap, non-return valve, 3/8" push fit connections and 3/8" polyethylene tubing to allow connection to a 1/2" BSP mains fitting to supply cold filtered water to the pillar tap
Note: If you have a different thread connection you will need to obtain alternative fittings to adapt your existing pipe work to the 3/8" tube supplied with this system
- 3.2 Choose a location next to your sink to install your new pillar tap. Ensure that there is enough space and access beneath the sink/work surface to allow installation of the tap fixings and filter pipe work
- 3.3 Position the filter in an upright position near to the incoming mains cold water supply and the existing kitchen tap and new pillar tap
- 3.4 Ensure that connecting pipe work will not have any sharp bends. Allow min 100mm (4") clearance below assembled filter for removal/service of the cartridge – see figure 1

4. Install the Pillar Tap – see figure 2.

- 4.1 A Ø 12.5mm hole is required to mount the tap into the sink/work surface
- 4.2 Assemble the collar (O), bezel (M) and o-ring (N) over the tap stem and push into the tap body with the o-ring facing downwards. Insert the tap stem through the tap mounting hole
- 4.3 Beneath the sink/work surface, place the plastic washer (Q) and lock washer (P) over the tap stem and secure the tap into position using the locking nut (R)
- 4.4 Screw the 7/16" tap adaptor (K) to the stem on your new pillar tap - do not over tighten

5. Install the adaptor to your cold water mains supply

- 5.1 Turn off the water supply and unscrew the fitting which connects your mains cold water supply to your existing kitchen tap
If your cold water supply pipe fitting has a 1/2" BSP Female connection – see figure 3
- 5.2 Connect the 1/2" Male Stem Adaptor (J) to the fitting on the mains cold water supply pipe - do not over tighten
- 5.3 Connect the 1/2" Female Adaptor (I) to the cold water feed on your existing kitchen tap - do not over tighten
- 5.4 Connect the Tee Adaptor (H) to the Stem Adaptor (J) on the mains cold water supply pipe
- 5.5 Measure the length and cut the tubing (F) required and use to connect the Tee Adaptor (H) to the cold water feed on your existing kitchen tap
If your cold water supply pipe fitting has a 1/2" BSP Male connection – see figure 4
- 5.6 Connect the 1/2" Female Adaptor (I) to the fitting on the mains cold water supply pipe - do not over tighten
- 5.7 Connect the 1/2" Male Stem Adaptor (J) to the cold water feed on your existing kitchen tap - do not over tighten
- 5.8 Connect the Tee Adaptor (H) to the Stem Adaptor on the cold water feed on your existing kitchen tap
- 5.9 Measure the length and cut the tubing (F) required and use to connect the Tee Adaptor (H) to the mains cold water supply pipe
Note: It is important that the tube ends are always cut square and that the tubes are pushed into the fittings and housing to a minimum of 18mm (0.75") to ensure a good seal

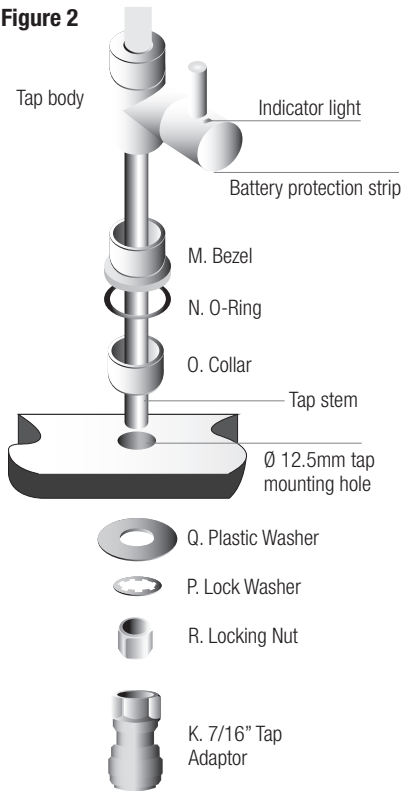

Figure 2

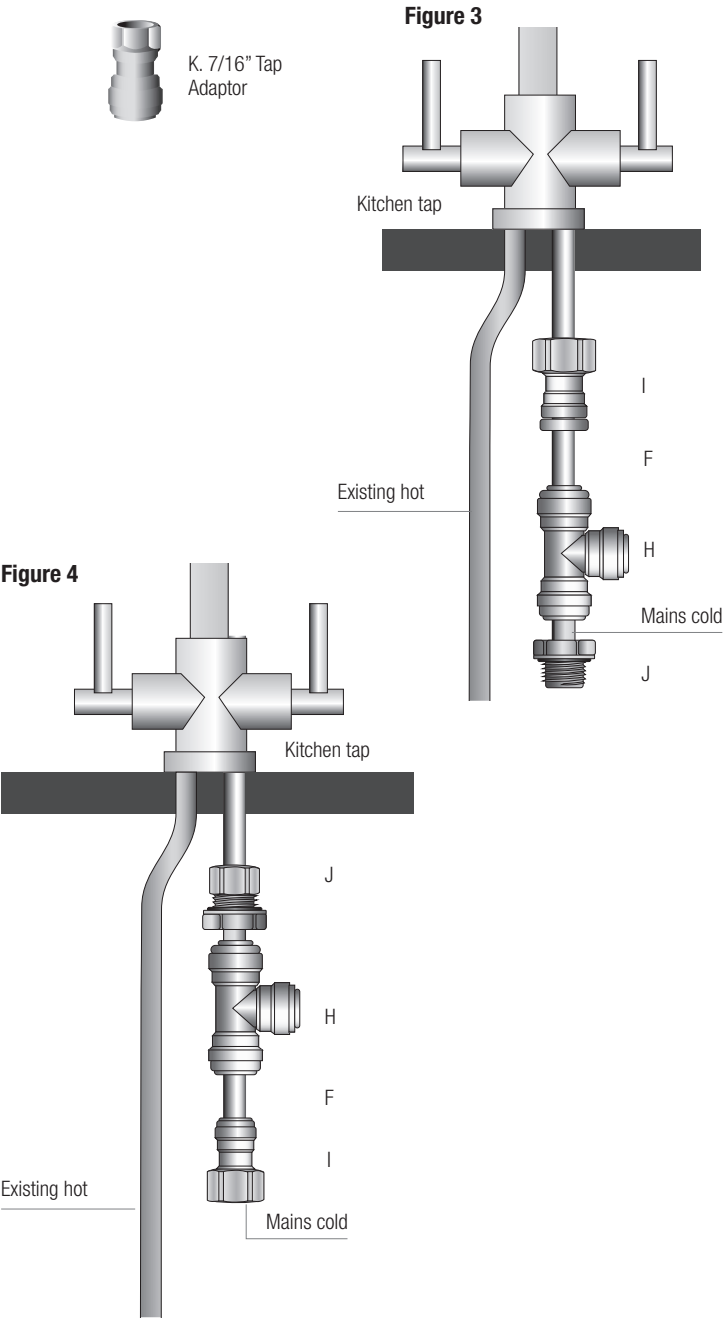
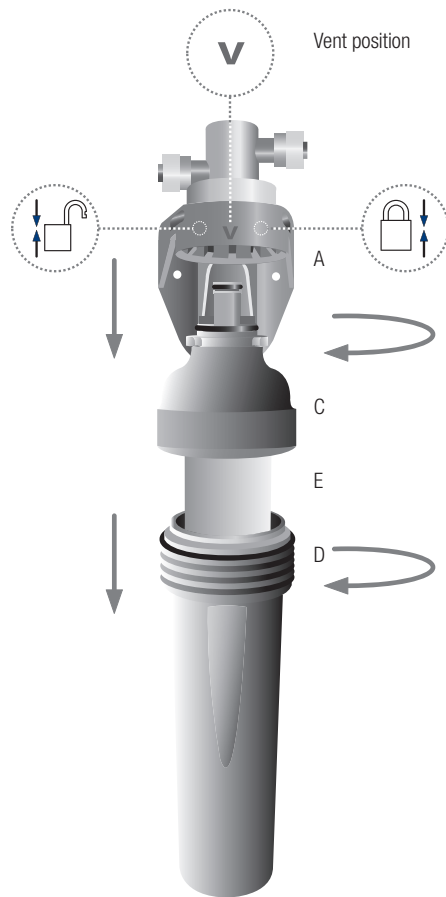

Figure 4

11. Servicing/Replacing the ceramic filter (E) – see figure 10

- 11.1 Grip the textured rim of the grey filter cap (C), twist to the ‘unlock’ position, taking care not to trap fingers and pull down to disengage.
- Note: If the filter has had little use prior to servicing, twist the grey filter cap (C) to the ‘V’ vent position and open the pillar tap (to relieve pressure in the filter) twist the grey cap to the ‘unlock’ position and pull down to disengage the filter whilst the pillar tap remains open**
- 11.2 The water supply is automatically turned off when the filter is dismantled.
Note: If the filter is to be left unattended whilst dismantled for an extended period of time (i.e. over 1 hour) then the upstream mains water supply should be turned off
- 11.3 Take the filter cartridge to the sink – remembering that it is still full of water
- 11.4 Unscrew the grey filter cap (C) to remove the filter body and empty the water into the sink, **taking care not to contaminate the open ended neck of the filter cap with unfiltered water**
- 11.5 Unscrew the ceramic filter (E) from the grey filter cap (C). **Note: Care must be taken to prevent contamination of the neck of the filter cap and ceramic filter mount stem**
- 11.6 Replace ceramic filter or clean as described in section 12 and then wash your hands. Note: If replacing with a new ceramic filter, prepare the filter for use as described in section 9 or as per the Operating and Exchange Instructions supplied with the replacement ceramic filter
- 11.7 The used ceramic filter can be wrapped in a plastic bag or newspaper for disposal with your household waste

Figure 10



12. Cleaning the ceramic filter – see figure 11

- Due to filtration of particulate contaminants from the water during use, the flow of water from the filter may reduce over a period of time. To restore flow to its normal level simply clean the ceramic filter as follows:
- 12.1 Hold the ceramic filter in a bowl of water or under running water. Ensure that the open ended plastic mount is clear of the water to avoid contamination
- 12.2 Take a clean kitchen scouring pad in one hand and cup it around the circumference of the ceramic filter at the top next to the mount. Press gently onto the ceramic filter surface with the scouring pad, whilst quickly turning the filter with the other hand
- 12.3 Apply a gentle even pressure with the pad and slowly work down the length of the ceramic filter once. Ensure that the cleaning is uniform over the whole filter

Figure 11

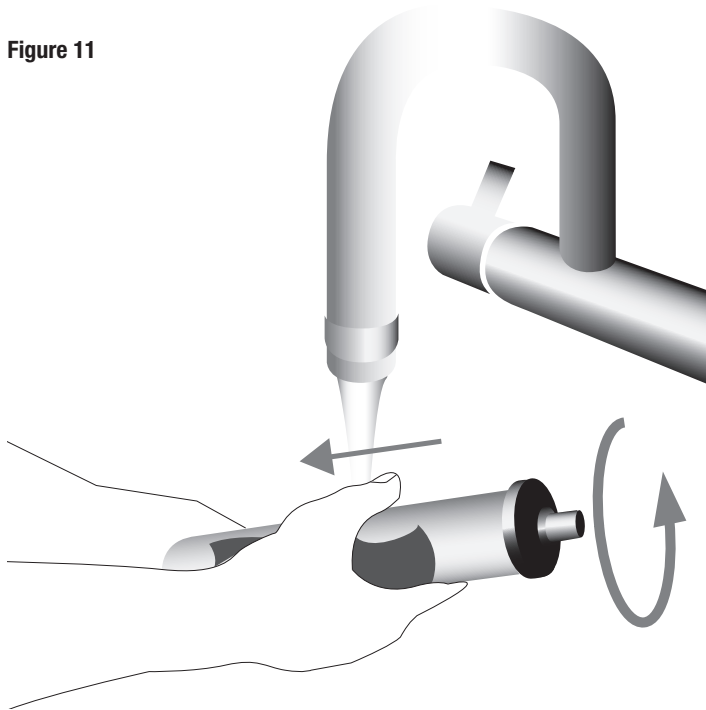

13. Re-setting the Pillar Tap indicator light or changing the battery – see figure 12

- When the ceramic filter has been changed the Pillar Tap indicator light will need to be re-set. To re-set the indicator light or change the battery, follow the steps below. It is recommended that a new pillar tap battery is fitted every 12 months
- 13.1 Remove the battery holder by pulling out from the underside of the pillar tap operating lever
- 13.2 Remove the battery
- 13.3 Re fit the new battery or if you are just re-setting the indicator light put the old battery back in. The led light on the circuit board will flash red then blue
- 13.4 Push the battery holder into the underside of the pillar tap operating lever, ensure the light on the circuit board aligns with the light lens. The indicator light is now re-set for use with the new ceramic filter, when the pillar tap is operated the indicator light flashes ‘blue’

Figure 12

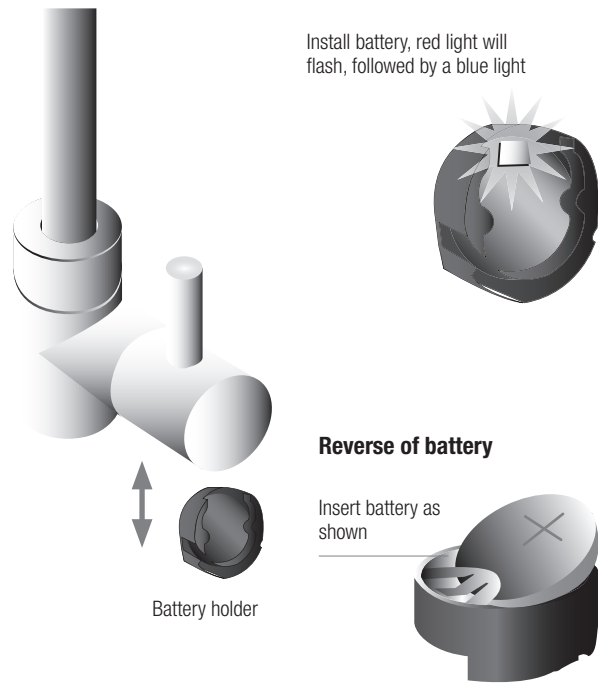

Parts and Service Availability - Buy online at **www.doulton.com**

Product Warranty - Your filter housing is covered under warranty for 12 months from the purchase date of the product against any failure due to defect of materials, workmanship or design of the filter housing. Please retain your receipt as proof of purchase. To register your product warranty please visit www.doulton.com/product-registration/ and complete the Product Registration Form.



MANUFACTURED BY FAIREY INDUSTRIAL CERAMICS LIMITED
Lyndale Cross, Lower Milehouse Lane, Newcastle-under-Lyme
Staffordshire, ST5 9BT. United Kingdom.
Telephone No. 44-1782-664420

www.doulton.com

Doulton® is a trademark registered to Fairey Industrial Ceramics Limited.